



Wood End Gardens, Northolt, UB5 4QL

Asking Price £460,000

## Wood End Gardens, Northolt, UB5 4QL

This three-bedroom semi detached house is ideally located within a ten-minute walk of Northolt Park Station. With potential for rear extension the property offers off-street parking to the front and also offers a buyer the chance to make the house their own.

- Semi Detached House
- Three Bedrooms
- Reception Room
- Kitchen
- Family Bathroom
- Garden
- Off Street Parking
- Gas Central Heating
- Short Walk To Station
- Potential Rear Extension STPP



**Council Tax Band: D**

Freehold



### **INTERNALLY**

This is a three bedroom semi detached house in need of refurbishment. The front door leads into lobby area with stairs to the first floor landing and door into the reception room. The reception room has a large front aspect window and to the rear is a archway leading into the kitchen. In the kitchen there is a door into a lobby area with door leading into the downstairs bathroom. The garden can be access via a door to the rear of the kitchen. Stairs to the first floor landing with doors leading off into master bedroom with storage cupboards another double bedroom and a single bedroom.

### **EXTERNALLY**

Off street parking. Rear garden with patio area and large laid to lawn, there is also side access from the front of the property.

### **LOCATION**

Wood End Gardens is conveniently located close to bus services and 0.6 miles to Northolt Park Station providing access to Marylebone and to Sudbury Hills Tube. Local schools include Greenwood Primary School 0.3 miles away, Wood End Infant School 0.5 miles away, Wood End Academy 0.6 miles away and The Welldon Park Academy 0.9 miles away.

### **ADDITIONAL INFORMATION**

Council Tax Band D - £1,841



## Floor Plan

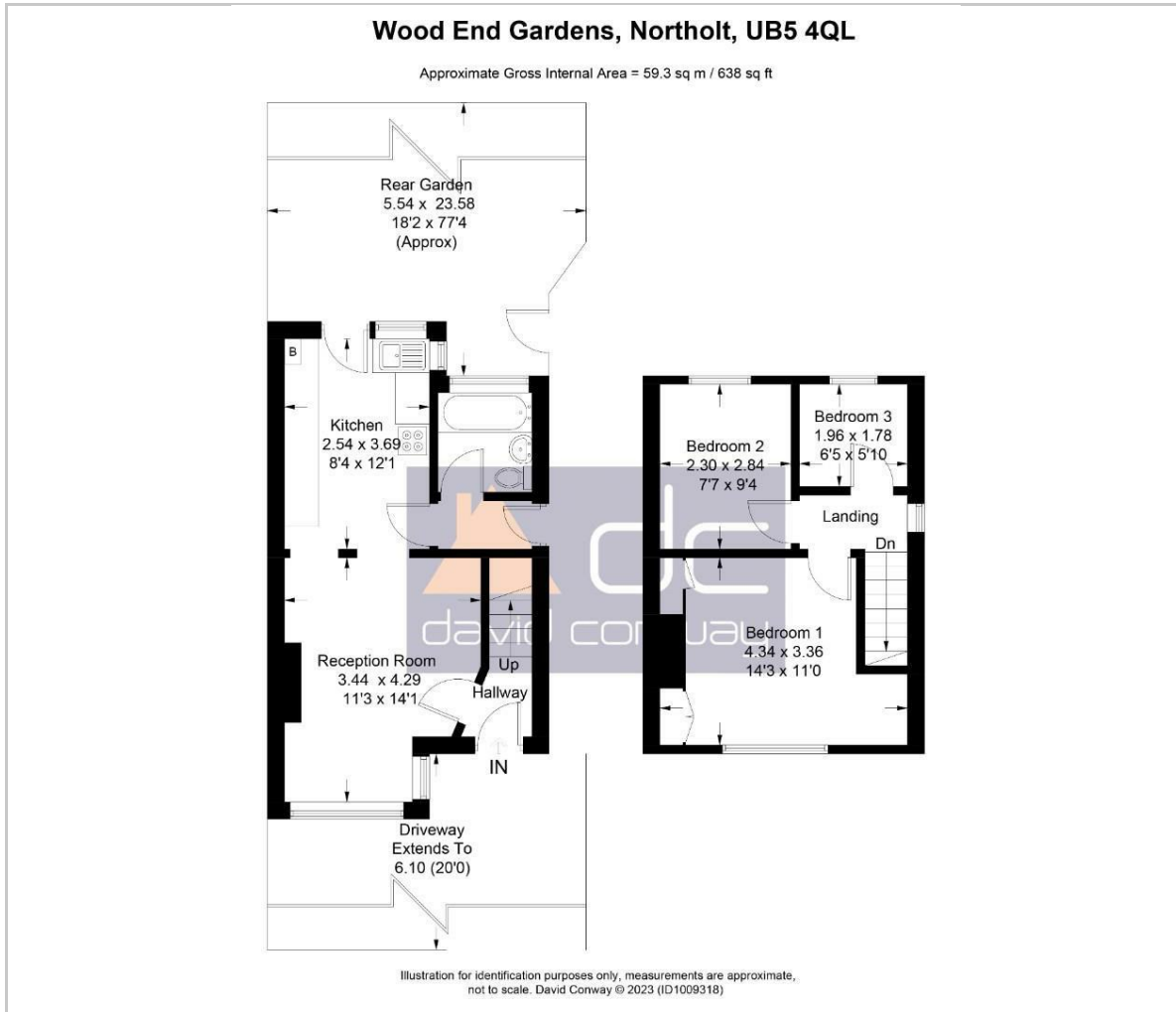

## Viewing

Please contact our David Conway & Co Ltd Office on 02084225222 if you wish to arrange a viewing appointment for this property or require further information.

These particulars, whilst believed to be accurate are set out as a general outline only for guidance and do not constitute any part of an offer or contract. Intending purchasers should not rely on them as statements of representation of fact, but must satisfy themselves by inspection or otherwise as to their accuracy. No person in this firm's employment has the authority to make or give any representation or warranty in respect of the property.

269 Northolt Road, Harrow, Middlesex, HA2 8HS  
 Tel: 02084225222 Email: sales@davidconway.co.uk <https://www.davidconway.co.uk/>

## Area Map



## Energy Efficiency Graph

